

BAG DECUFFER SEALER DS-41

The DS-41 automatically **decuffs, stretches and heat seals the bag**. The DS-41 perfectly closes up to 16 bags per minute - even randomly with multiple box sizes.

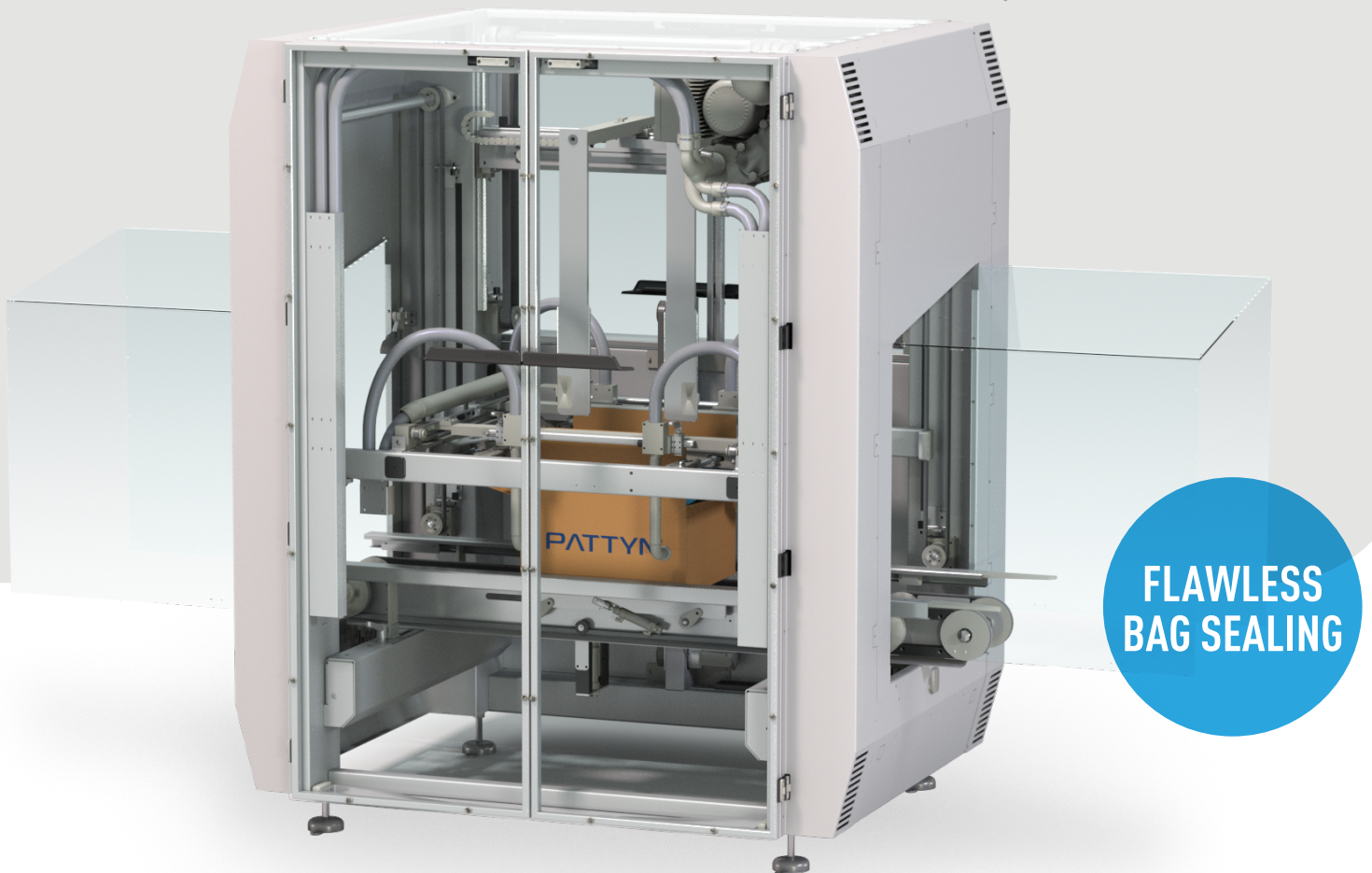
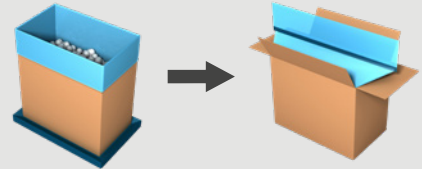

Protect your product

- **Optimal bag control** to guarantee a **perfect seal**
- Simple design & minimal moving parts above the case
- Perfect cleanability

Built for efficiency

- Up to **16 cases/minute**.
- **Large box range**.
- **Can run multiple box sizes randomly**.
- **Very low energy consumption**
- **Intuitive 15" HMI**.



Watch our videos
at pattyn.com

TECHNICAL SPECIFICATIONS

Perfect seal

- Improved stretcher movement ensures lower impact on case flaps.
- Intelligent stepper driven stretchers for correct film tension and tension release before sealing.
- Impulse heat sealing from both sides.
- Decuffer control for film detection (optional).
- Dust-free vacuum decuffing for maximum food safety.
- Servo driven up and down movement of the sealing frame.

Hygienic balcony design, easy to clean

- Cleaning mode: to facilitate an improved cleaning accessibility.

Equipped with:

- Intuitive 15" color HMI



Vacuum bag decuffers



Decuffer control (optional)

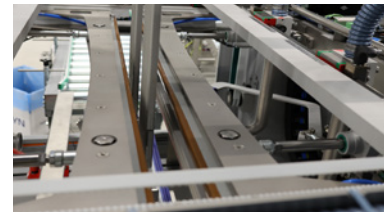

Impulse heat sealing from both sides

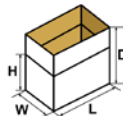
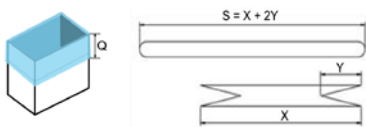

15" HMI

CONTAINER SPECIFICATIONS (For other dimensions, please contact Pattyn)	
Type	Cases, trays
Range (L x W x H // D) inches	Min. 9" (L) x 7" (W) x 4" (H) Max. 25" (L) x 16" (W) // 25" (D) Trays / Crates: Minimum height 8"
	MAX version: Min. 15" (L) x 10" (W) // 4" (H) Max. 31" (L) x 23" (W) // 31" (D) Outside dimensions
FILM SPECIFICATIONS	
Type	PE (LDPE, HDPE)
Thickness	As from 0.4 mil
	$S = X + 2Y$ $X = L + 15$ $Y = (W + 25) / 2$ $S = \max 42.5"$ $L + W + 40 \leq S \leq L + W + 90$ $5.5" \leq Q \leq 7"$
OUTPUT AND CONSUMPTION	
Output	Up to 16 c/min Up to 15 c/min for oils & fats
Installed power	15 kW
Voltage	3 x 400V + E / 50 Hz
Air supply	90 PSI, (1/2" min)
Air consumption	2 ft ³ / cycle
Weight	2,205 lbs
OPTIONS (More options are available, please contact Pattyn)	
MAX version for large box footprints	
Film detection with decuffer control	
Two lines sealing - double sided heating	
Mechanical bag decuffing	

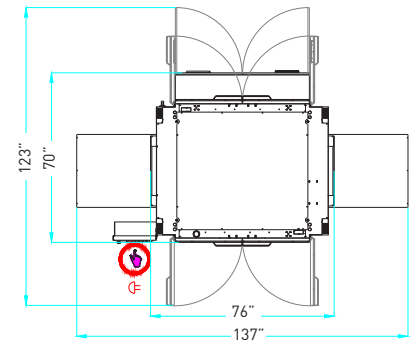

Machine height 86"

Pattyn North America Inc.
N56W24660 N. Corporate Circle
Sussex, WI. 53089 - U.S.A

Ph +1 262-966-0300
SalesUsa@pattyn.com



The description, pictures and information given have an indicative value. We reserve the right to make changes without notice. Information and content are property of Pattyn. For customized executions please contact Pattyn.



Turnkey solutions for industrial packaging.