

PATTYN®

BAG DECUFFER FOLDER DF-31

The compact DF-31 automatically decuffs, regussets and closes the bag by folding.

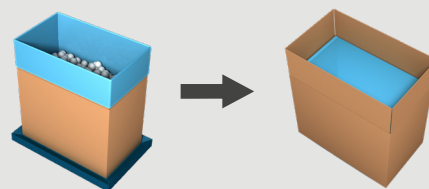

COMBINE WITH
**THE CASE
CLOSER**

Protect your product

- The DF-31 guarantees a **perfect bag folding** to avoid contact between the product and carton.
- Minimal moving parts above the filled case.
- **Reclosable.**

Maximize your productivity

- Up to **17** cases / minute.
- **Big box range.**
- Quick format change.
- Maximum uptime by design and interconnectivity.
- **15" HMI** to facilitate operator convenience.



Watch our videos
at pattyn.com

TECHNICAL SPECIFICATIONS

Perfectly controlled bag overlap folding

- Decuffing before folding.
- Regussetting and bi-directional folding ensures perfect bag closing and avoids contact between product and carton.

High speed

- Heavy duty roller conveyor and stopper system for high speed case transfer of filled boxes.

Hygienic design, easy to clean

- Cleaning mode: to facilitate an improved cleaning accessibility.

Standard equipped with

- 15" HMI for easy operation.
- Remote access point (one per line)
- Mechanical bag decuffing

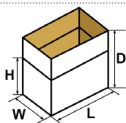
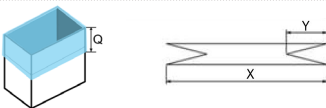
| CONTAINER SPECIFICATIONS (For other dimensions, please contact Pattyn) | |
|---|--|
| Type | Cases, trays, boxes, crates |
| Range (L x W // D) inches | Multi footprint Min. 11.8" (L) x 7.8" (W) x 3.9" (H) * Max. 25 1/2" (L) x 16.1" (W) // 25 1/2" (D) *Trays minimum height 8" |
|  | Outside dimensions |
| FILM SPECIFICATIONS | |
| Type | PE (LDPE, HDPE) |
| Thickness | As from 0.3 mil |
|  | $X = L + 5/8"$ $Y = (W + 1 3/4") / 2$ $5 1/2" \leq Q \leq 7"$ |
| OUTPUT AND CONSUMPTION | |
| Output | Up to 17 c/min Up to 15 c/min for oils & fats |
| Installed power | 2 kW |
| Voltage | 3 x 480V + E / 60 Hz |
| Air supply | 87 PSI, (1/2" min) |
| Air consumption | 0.7 ft³ / cycle |
| Weight | 1653 lbs |
| OPTIONS (More options are available, please contact Pattyn) | |
| Decuffer control on regussetting bars for film detection | |
| Automatic format change | |
| Vacuum bag decuffing | |



vacuum bag decuffing (optional)



The gusset plates regusset the film



Front film folder



15 " HMI

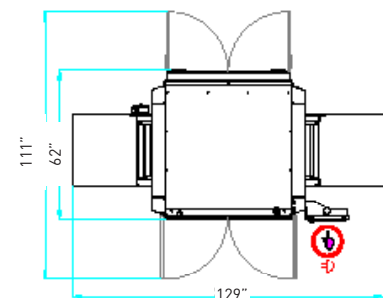

Machine height 94"

Pattyn North America Inc.
N56W24660 N. Corporate Circle
Sussex, WI 53089 - U.S.A.

Ph +1 262-966-0300
Fax +1 262-966-0312
SalesUsa@pattyn.com



The description, pictures and information given have an indicative value. We reserve the right to make changes without notice. Information and content is property of Pattyn. For customized executions please contact Pattyn. DF-31 2021 - V01

PATTYN®

Turnkey solutions for industrial packaging.